

CRUISECRAFT 3



Chelsea Bootsman, RED DEER, AB

PACK A LARGE CREW!

The **CruiseCraft 3** is outfitted with luxurious amenities for your Shuswap Lake adventure, including air conditioning and a fireplace to control your indoor climate. The distinctive interior includes a spacious salon and galley area along with five private staterooms, a bunk room and 2 cuddies with double beds - plus all the appliances you can imagine including a stacked washer/dryer and mini bar fridge. The home theatre entertainment centre comes with a DVD player. A fuel transfer station is included on the aft deck.

MAIN DECK

- 3 Staterooms with double beds
- 1 Bunk Room with two double beds
- Convert the sofa and dinette into double beds
- 2 Double Cuddies
- 2 Full Baths - toilet, sink, shower
- Appliances incl. 25 cu.ft. fridge/freezer, range microwave and dishwasher
- Stacked washer / dryer
- Fireplace

- BBQ
- Salon Wet Bar
- TV/CD/DVD and home theatre entertainment centre
- Air conditioning in salon

BRIDGE DECK

- 2 Staterooms with queen size beds and TV/DVD
- Hot Tub & Suntan Area
- Wet Bar
- Bimini Top
- Slide

SLEEPS UP TO **22**

Ideal for 6 couples or 4 families.

16' x 70'. approx. 2200 sq.ft.

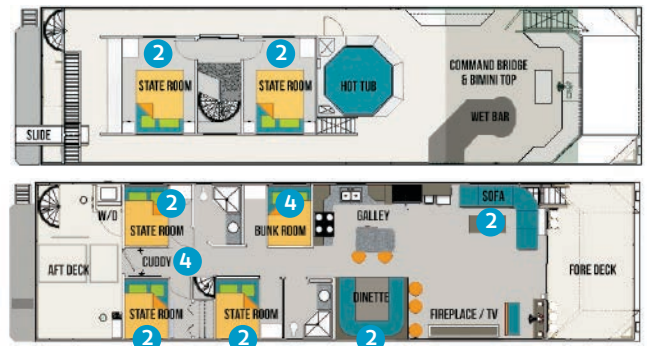

PRICES IN CANADIAN DOLLARS.
TAXES ADDITIONAL.

MERCURY
MerCruiser

3 NIGHTS 4 NIGHTS 7 NIGHTS
LOW \$2782 \$3507 \$4473

3 NIGHTS 4 NIGHTS 7 NIGHTS
MID \$5145 \$5733 \$7366

3 NIGHTS 4 NIGHTS 7 NIGHTS
PEAK \$5806 \$6368 \$10,254