

CRUISECRAFT 1



A CLASSIC HOUSEBOAT!

The **CruiseCraft 1** is ideal for those wanting the comforts of home while keeping vacation costs on a budget. Outfitted with Twin Anchors' classic amenities for your Shuswap Lake adventure, you'll find a hot tub, fireplace, upper sink and BBQ. The galley is home to a full slate of appliances and all the basic utensils, while the staterooms provide comfortable beds and storage areas for your gear. The loft is a favourite sleeping area for the kids or those young at heart.

MAIN DECK

- 2 Staterooms with double beds
- 1 Bunk Room with single bed and a double bed
- Convert the sofa and dinette into double beds
- 1 1/2 baths - toilet, sink, shower
- Appliances incl. two 8 cu.ft. fridges, range and microwave
- TV/CD/DVD entertainment centre
- Fireplace

- BBQ
- Rear access to bridge deck
- Remote fuel station

BRIDGE DECK

- Hot Tub
- Suntan area
- Wet bar
- Loft with 2 double beds
- Slide

SLEEPS UP TO **15**

Perfect for 3 couples or 2 families.
14'6" x 56'. approx. 1624 sq.ft.

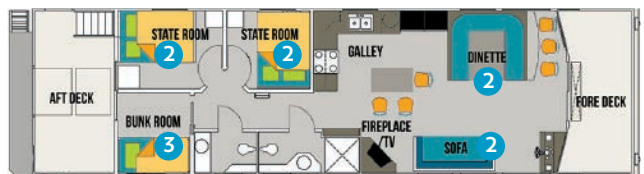
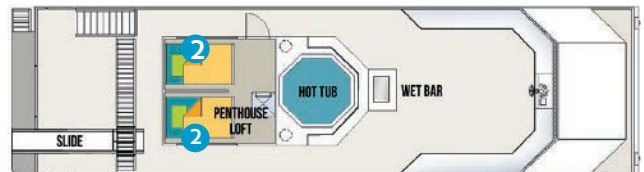

PRICES IN CANADIAN DOLLARS.
TAXES ADDITIONAL.

MERCURY
MerCruiser

3 NIGHTS 4 NIGHTS 7 NIGHTS
LOW \$1785 \$1995 \$2677

3 NIGHTS 4 NIGHTS 7 NIGHTS
MID \$2688 \$2989 \$4079

3 NIGHTS 4 NIGHTS 7 NIGHTS
PEAK \$3087 \$3197 \$5240