



USED HOUSEBOATS FOR SALE

1999 CRUISECRAFT II 6015 "Tropical Dream"

Viewing available 7 days a week



specifications

LENGTH 60'
BEAM 14'6"
PROPULSION Merc 3.0
APPROX. HOURS

features

Propane Furnace & Hot Water Tank
8 Person Hot Tub
Generator
Fully Equipped Galley (dishes, utensils etc.)

accommodation

SLEEPS 15
STATEROOMS 2 - Double Beds
BUNKROOM 1 - 1 Dble.; 1 Twin
LOFT Yes - 2 Double Beds
SOFA 1 - Converts
DINING Convertible Dinette
HEADS 1 1/2 Baths

audio/visual

TV/DVD
CD STEREO
VHF RADIO

appliances

Stove, two 8.5 cu.ft. Norcold Refrigerator, microwave, and dishwasher

location: SICAMOUS, BC
moorage: SHUSWAP LAKE
price: \$134,900



Twin Anchors Marine
a division of Twin Anchors Marine (1977) Ltd.
675 Old Town Road, PO Box 318
Sicamous, BC V0E 2V0 Canada
Tel. 250.836.3028 Fax. 250.836.3038
www.twinanchors.com

sales contacts:

Todd Kylo 250.836.2450 todd@twinanchors.com
Nigel Watson 250.463.2000 nwatson@twinanchors.com



USED HOUSEBOATS FOR SALE

1999 CRUISECRAFT II 6015 "Tropical Dream"

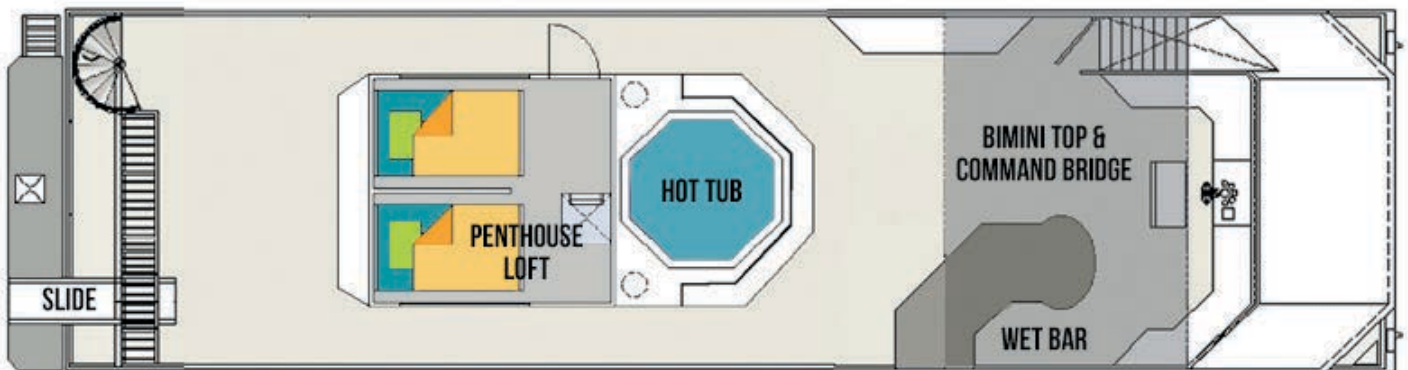
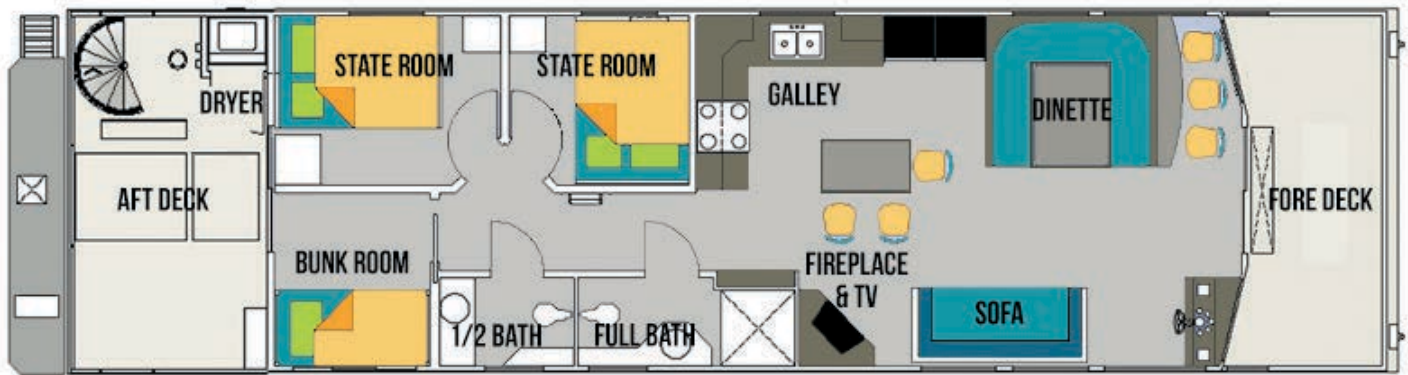

Twin Anchors Marine
a division of Twin Anchors Marine (1977) Ltd.
675 Old Town Road, PO Box 318
Sicamous, BC V0E 2V0 Canada
Tel. 250.836.3028 Fax. 250.836.3038
www.twinanchors.com

sales contacts:

Todd Kylo 250.836.2450 todd@twinanchors.com
Nigel Watson 250.463.2000 nwatson@twinanchors.com