

EXCURSION > 7516

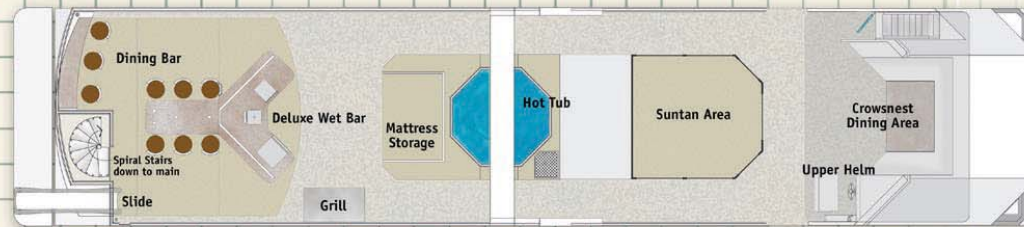

BRIDGE DECK

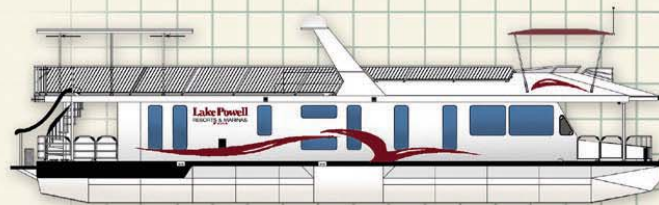
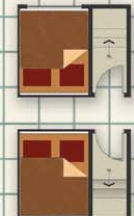

2 Lower Staterooms

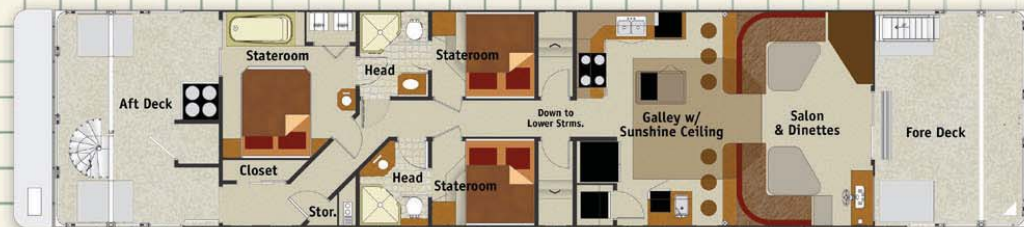

MAIN DECK

CRUISECRAFT 7516 - 5 Staterooms

| | |
|--------|-----|
| Length | 75' |
| Beam | 16' |

TANKAGE

| | |
|----------------------------|-------------------------|
| Fuel | 230 Gal. (2 @ 115 Gal.) |
| Additional "Toy" Fuel Tank | 100 Gal. |
| Water | 80 Gal. (single tank) |
| Holding | 700 Gal. (2 @ 350 Gal.) |
| Propane | 160 lbs (4 @ 40 lbs.) |

FLOTATION

Aluminum twin high buoyancy pontoons with sealed bulkheads 5' o.c. and 8' nose cones.

specifications

STRUCTURAL

| | |
|--------------------------------|-------------------------------------|
| 3 - Ensuite Staterooms (queen) | Crowsnest Dining Area |
| 2 - Lower Cuddy Cabins (queen) | Vaulted Ceiling and Suntan Platform |
| Radar Arch / Bimini Top | Mattress Storage |
| 8 Person Hot Tub | Designer "Y" Wet Bar |

RAILS, LADDERS & ACCESSORIES

| | |
|------------------------------|----------------------------------|
| Powdercoated Rails / Ladders | Retractable Boarding Ramp |
| Spiral Staircase | Raised Dining Bar across Fantail |
| Waterslide | Molded Fiberglass Hardtop |
| TV Cabinet on Bridge Deck | Foredeck Access |

MECHANICAL FEATURES & OPTIONS

| | |
|-------------------------------------|--|
| Twin Mercruiser 4.3 MPI V6 Bravo II | 20KW Generator w/ vertical stack exhaust |
| Hydraulic Steering System | Electronic Controls |

HEATING & COOLING OPTIONS

| | |
|----------------------------------|--------------------------------|
| Central Air - 4.0 Ton split unit | 35,000 BTU Forced Air Furnace |
| Propane Fireplace | Designer Ceiling Fans - galley |

PLUMBING FEATURES & OPTIONS

| | |
|--------------------------------------|---|
| 2 - Heads | 2 - Vanity Sinks |
| Double Stainless Steel Sink - galley | 2 - Neo-Angle Showers |
| Pressurized Water System | Master Stateroom Vanity Sink & Soaker Tub |

ELECTRICAL FEATURES & OPTIONS

| | |
|---|--------------------------------|
| Deluxe 110v/12v Electrical Panel w/meters | 2 - 3000 Watt Inverters |
| Start Batteries 3 - 12 volt | Satellite Input on Bridge Deck |
| Cabin Batteries 16 - 6 volt deep cycle | Custom Lighting throughout |

APPLIANCES & ELECTRONICS

| | |
|--------------------------------------|-----------------------------------|
| 25 cu.ft. Refrigerator/Freezer | 30" Residential Range |
| Micro-Convection over the Range | Dishwasher & Freezer |
| Trash Compactor & Ice maker | Bar Fridge & Wine Cooler |
| Wide Screen TV & Home Theatre System | Tracking Satellite Dish |
| LCD TVs w/DVD in Staterooms | X-Box or Playstation III in Salon |
| 2 - 10 Gallon Hot Water Heaters | 2 - Weber Barbecues |

CABINETS & MILLWORK

| | |
|---|--|
| Cabinet features: plywood countertops, toe kicks and drawer construction, raised hardwood doors, European adjustable hinges. Custom plastic laminate countertops. | Solid Oak Cabinet Doors |
| Staterooms with hanging lockers & nightstands | Pantry in Galley with swing door |
| | Hinged Island Bed w/storage under |
| | Fireplace / Entertainment Center Cabinet |
| | Interior Storage Lockers |

CABIN FINISHING / FURNISHINGS

| | |
|---------------------------------------|--|
| Solid Oak casings, moldings and bases | Carpet and vinyl flooring throughout |
| Yacht Headliner | 5" Quilted Foam Mattresses |
| 2 - "L" shaped convertible dinettes | Padded valences and decorative side curtains |
| Pleated Shades throughout | 6 Dining Stools |

SAFETY

| | |
|--|-----------------------|
| Navigation Lights | Twin Trumpet Horns |
| Ships Bell | Propane/CO Detectors |
| Intercom - galley to bridge deck wet bar | Fish Finder / Compass |
| Vertical Stack Exhaust | Backup Camera |

LAKE POWELL RESORTS & MARINAS

Lake Powell's most luxurious houseboat rentals